

BASE FLASHING INSIDE CORNERS - ISO VIEW (OPTION 2: MITER CUT)

METAL COPING,
INSTALLED AS SPECIFIED

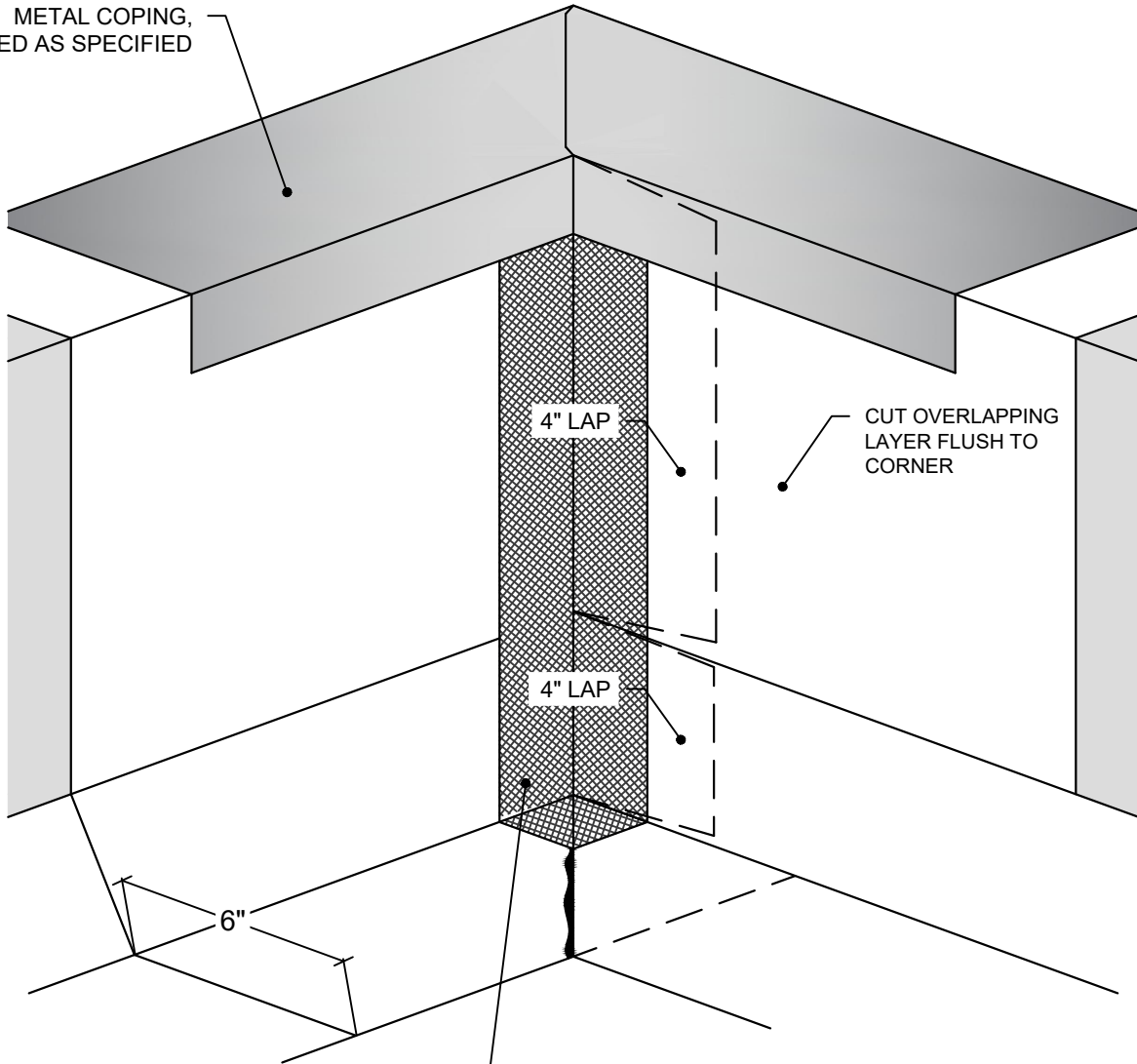

4" LAP

CUT OVERLAPPING
LAYER FLUSH TO
CORNER

4" LAP

6"

WEB REINFORCEMENT
INSTALLED AS SHOWN

3 COURSE APPLICATION:

LAYER 1: SBS MASTIC OR TROWEL-GRADE ACRYLIC

LAYER 2: WEB REINFORCEMENT

LAYER 3: SBS MASTIC - UV SURFACING (OPTIONAL)
OR TROWEL-GRADE ACRYLIC

OR CAP SHEET PATCH IN SBS MASTIC

LOW SLOPE 25B - ISO



Rev. 10/21

PROJECT NAME:

DATE:

SCALE: NOT TO SCALE

ADDRESS:

PROJECT NO:

DRAWING NO. :

OWNER:

SUBMITTAL NO. :