

BASE FLASHING FOR GYPSUM WALL ON METAL STUDS - ISO VIEW

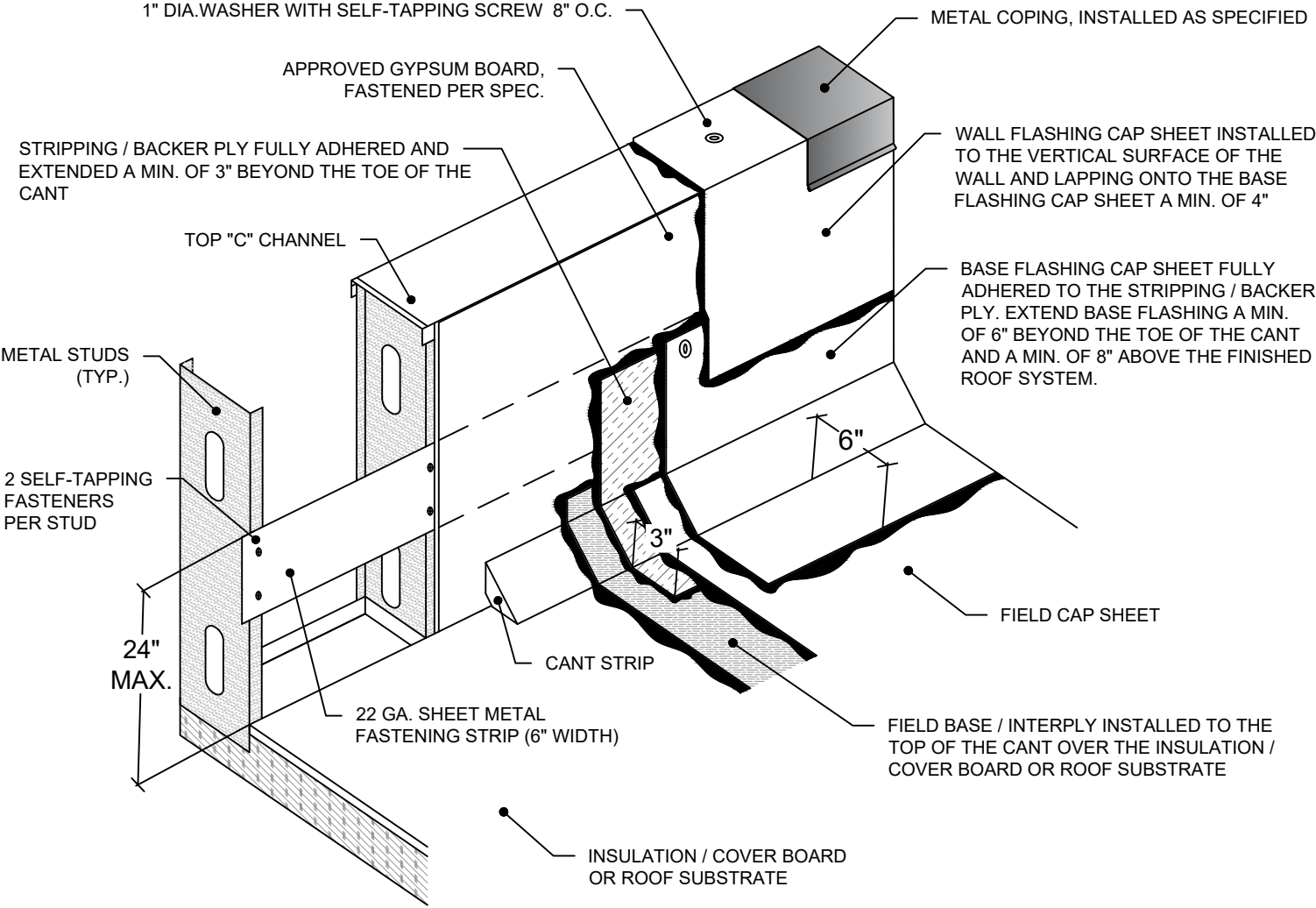

- NOTES:**
1. INSTALL ROOF INSULATION TO THE BASE OF THE WALL IF APPLICABLE.
 2. INSTALL CANT STRIP AT THE ROOF TO WALL TRANSITION.
 3. INSTALL FIELD BASE / INTERPLY ROOFING SYSTEM TO THE TOP OF THE CANT OR ABOVE.
 4. FULLY ADHERE STRIPPING / BACKER PLY TO THE VERTICAL SURFACE OF THE WALL AND FIELD BASE / INTERPLY. EXTEND A MINIMUM OF 3" PAST CANT.
 5. INSTALL FIELD CAP SHEET OVER THE STRIPPING / BACKER PLY TO THE TOP OF THE CANT.
 6. INSTALL BASE FLASHING CAP SHEET A MIN. OF 6" BEYOND THE TOE OF THE CANT AND ABOVE THE FINISHED ROOF SYSTEM A MIN. OF 8" TO A MAX. OF 24". FASTEN THE TOP OF THE BASE FLASHING TO METAL STRIP W/ SELF-TAPPING FASTENERS W/ 1" MIN. WASHERS @ 8" O.C.
 7. INSTALL WALL COVERING AS ILLUSTRATED ABOVE.

LOW SLOPE 7 - ISO

 <p>Malarkey Roofing Products® Defining Excellence.™</p>	PROJECT NAME:	DATE:
	ADDRESS:	SCALE: NOT TO SCALE
	OWNER:	PROJECT NO:
		DRAWING NO. :
Rev. 11/20		SUBMITTAL NO. :