

SCUPPER - SECTION VIEW

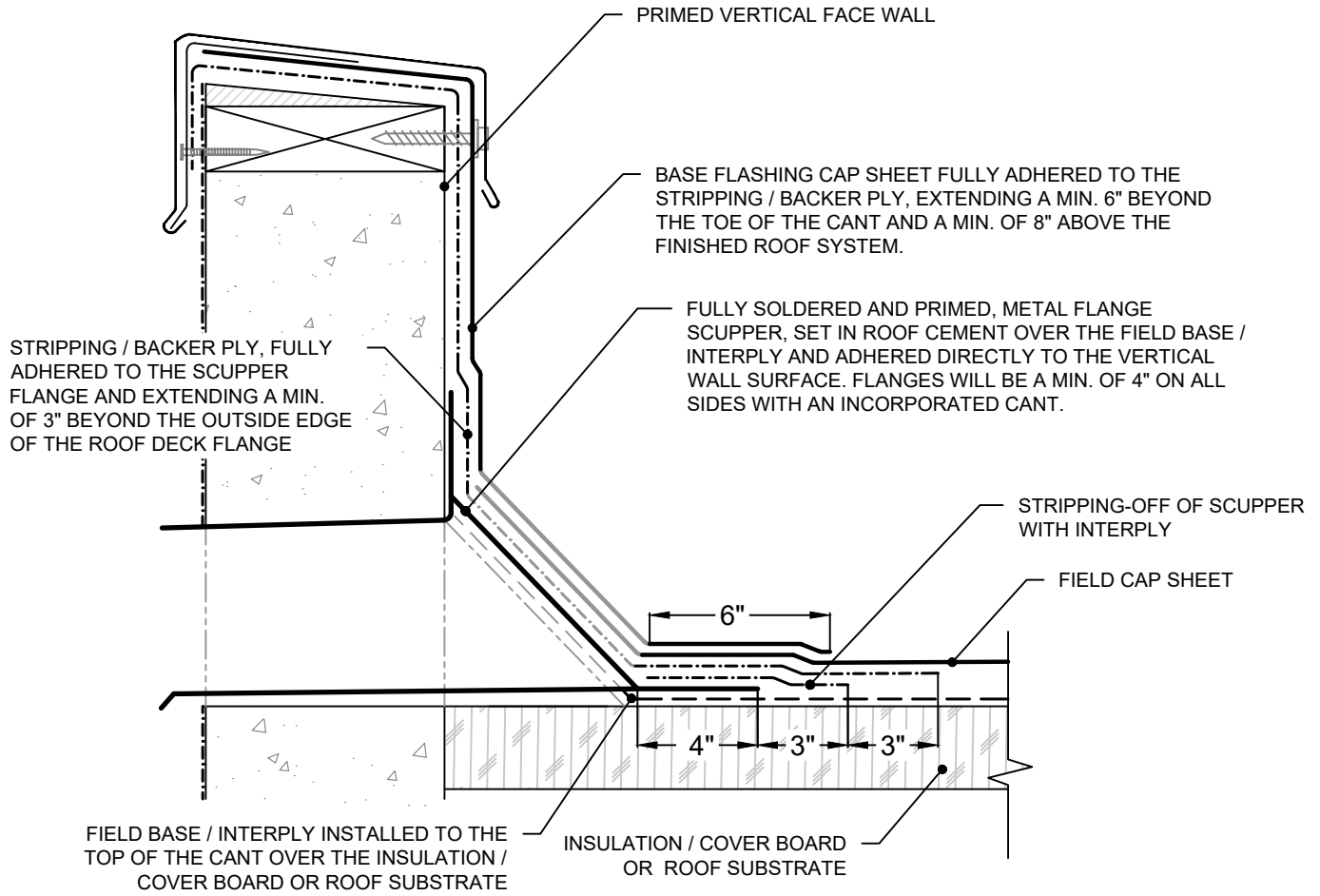

NOTES:

1. SCUPPER WILL BE MADE TO ALLOW MINIMAL DISTANCE BETWEEN THE SCUPPER AND WALL OPENING.
2. INSTALL FIELD BASE / INTERPLY TO THE TOP OF THE CANT AND CUT OPENING FOR THE ROOF SCUPPER.
3. SET PRIMED ROOF SCUPPER INTO A LAYER OF ROOF CEMENT AND SECURE TO THE WALL AND ROOF DECK WITH FASTENERS AT A SPACING OF 4" ON CENTER.
4. STRIP-OFF THE SCUPPER FLANGES WITH INTERPLY.
5. INSTALL THE STRIPPING / BACKER PLY OVER THE WALL AND ADHERE TO THE SCUPPER FLANGES. EXTEND A MIN. OF 3" BEYOND THE OUTSIDE EDGE OF THE ROOF DECK FLANGE.
6. INSTALL FIELD CAP SHEET OVER THE STRIPPING / BACKER PLY TO THE TOP OF THE CANT.
7. INSTALL BASE FLASHING CAP SHEET AS SHOWN; EXTEND A MIN. OF 6" BEYOND THE TOE OF THE CANT AND A MIN. OF 8" ABOVE THE FINISHED ROOF SYSTEM.
8. FOR NON-LEAD, FLANGED ROOF SCUPPERS THAT REQUIRE MECHANICAL ATTACHMENT: INSTALL PRESSURE-TREATED WOOD BLOCKING TO THE ROOF DECK, DIRECTLY UNDER THE SCUPPER AREA TO ALLOW FOR MECHANICAL ATTACHMENT IF THERE IS INSULATION AND A COVER BOARD.

LOW SLOPE 15 - SEC



Rev. 1/21

PROJECT NAME:

DATE:

SCALE: NOT TO SCALE

ADDRESS:

PROJECT NO:

DRAWING NO. :

OWNER:

SUBMITTAL NO. :