

RAISED PERIMETER EDGE WITH METAL CAP-FASCIA FLASHING - SECTION VIEW

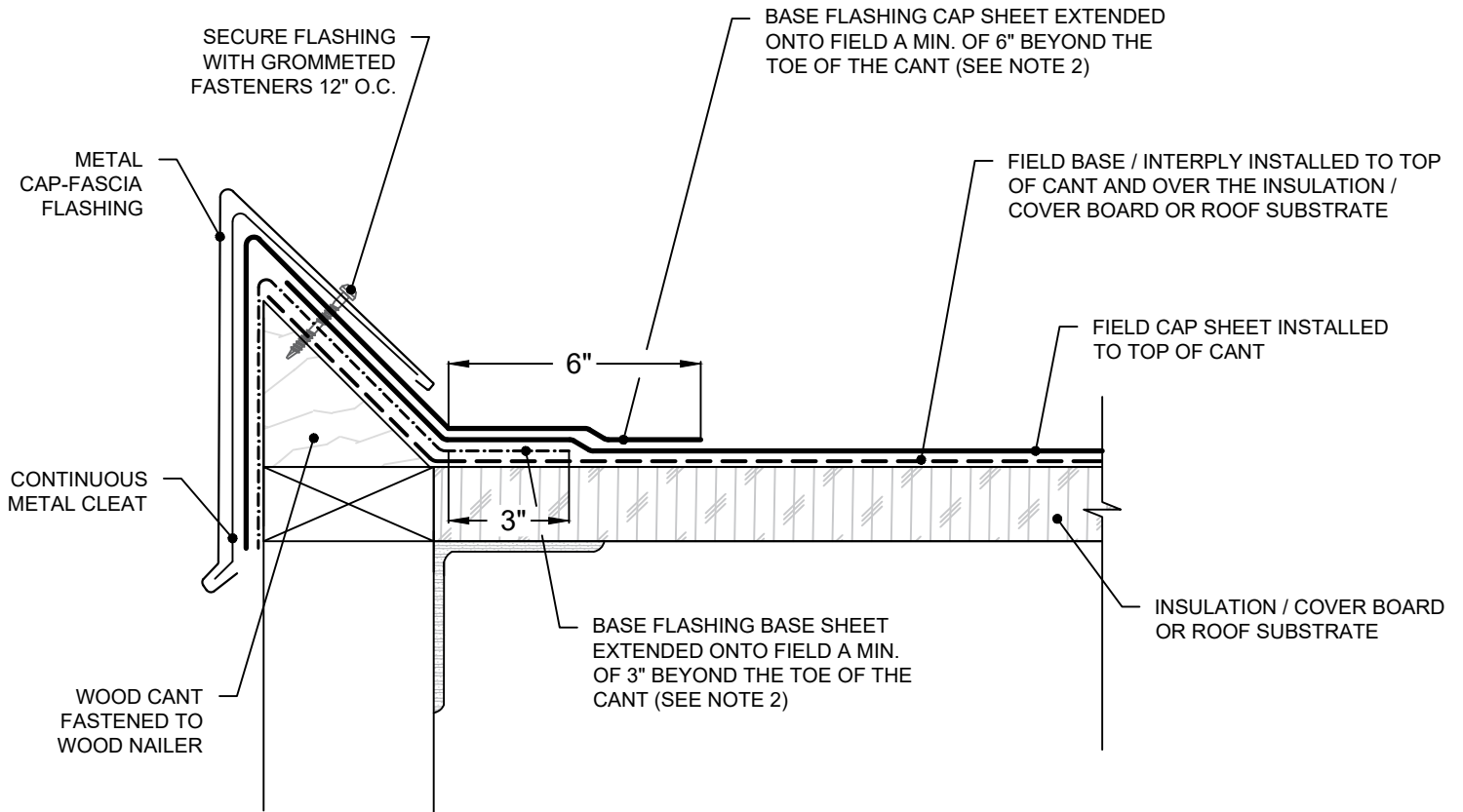

NOTES:

1. WHEN INSTALLING WITH INSULATION AND/OR COVER BOARD, WOOD NAILER MUST BE INSTALLED AT ROOF EDGE, MATCHING THE HEIGHT OF INSULATION / COVER BOARD.
2. EXTEND BASE FLASHING BASE AND CAP SHEETS OVER TOP OF CANT AND DOWN THE FACE 3/4" PAST THE NAILER / SHEATHING.
3. LAP METAL-CAP FASCIA FLASHING A MINIMUM OF 4"; INSTALL SEALANT IN THE LAP AND SECURE WITH GROMMETED FASTENERS.

LOW SLOPE 19 - SEC



Rev. 4/21

PROJECT NAME:

DATE:

SCALE: NOT TO SCALE

ADDRESS:

PROJECT NO:

DRAWING NO. :

OWNER:

SUBMITTAL NO. :