

LOW CONCRETE OR CMU WALL BASE FLASHING SECTION VIEW

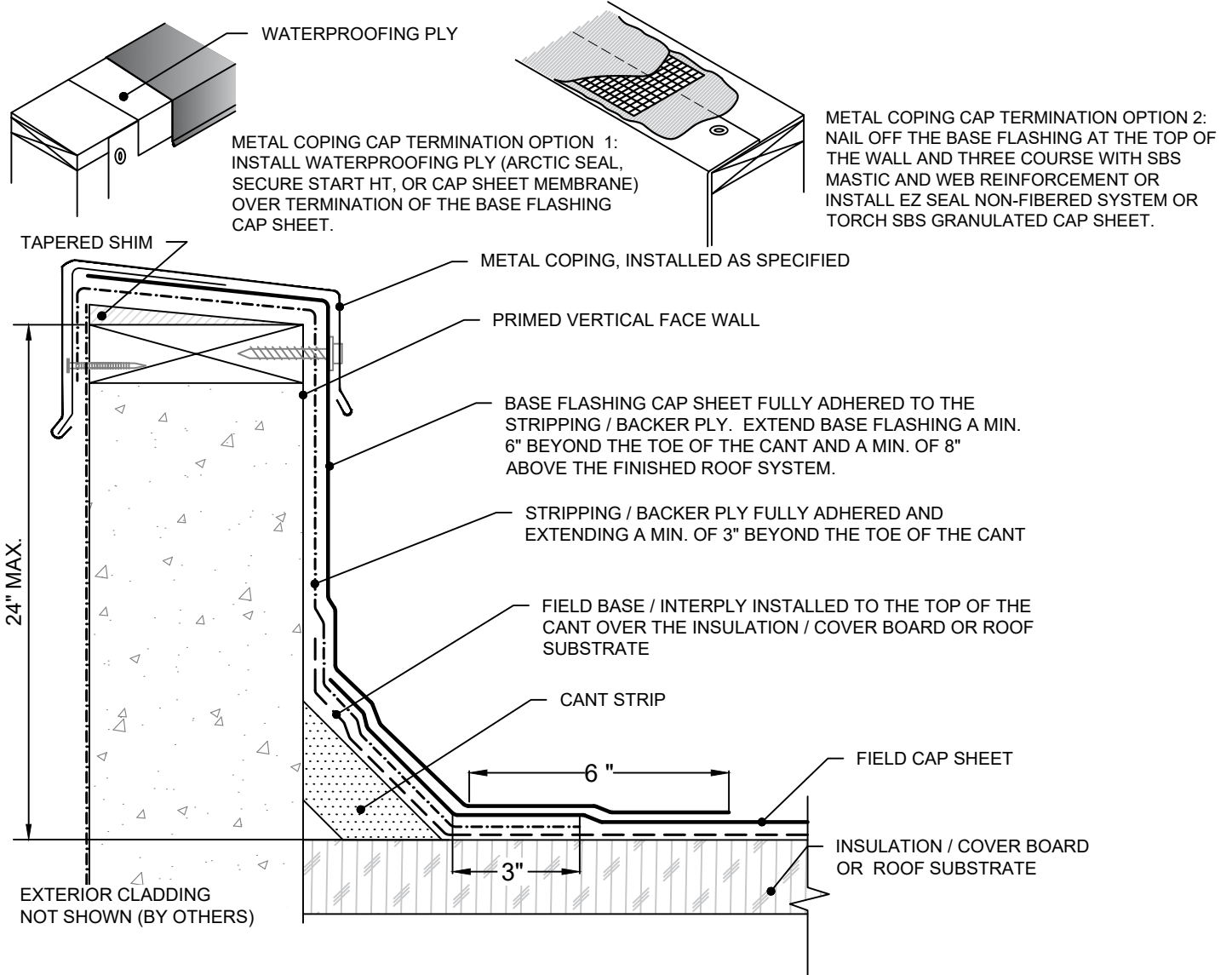

NOTES:

1. INSTALL ROOF INSULATION TO THE BASE OF THE WALL IF APPLICABLE.
2. INSTALL CANT STRIP AT THE ROOF TO WALL TRANSITION.
3. INSTALL FIELD BASE / INTERPLY ROOFING SYSTEM TO THE TOP OF THE CANT OR ABOVE.
4. INSTALL STRIPPING / BACKER PLY TO THE VERTICAL SURFACE OF THE WALL AND EXTEND A MINIMUM OF 3" PAST CANT.
5. INSTALL FIELD CAP SHEET OVER THE STRIPPING / BACKER PLY TO THE TOP OF THE CANT.
6. INSTALL BASE FLASHING CAP SHEET A MIN. OF 6" BEYOND THE TOE OF THE CANT AND ABOVE THE FINISHED ROOF SYSTEM A MIN. OF 8" TO A MAX. OF 24". IF NOT COMPLETELY WRAPPING THE TOP OF THE WALL, MECHANICALLY FASTEN THE TOP OF THE BASE FLASHING USING 1" DIAMETER CAP CONCRETE FASTENERS, 8" O.C.
7. INSTALL WALL COVERING AS ILLUSTRATED ABOVE.
8. WHEN APPLICABLE, VAPOR RETARDER SHOULD EXTEND VERTICALLY TO A POINT NOT LESS THAN 3" ABOVE THE TOP OF THE INSULATION / COVER BOARD.

LOW SLOPE 2 - SEC



Rev. 9/21

PROJECT NAME:

ADDRESS:

OWNER:

DATE:

SCALE: NOT TO SCALE

PROJECT NO.:

DRAWING NO. :

SUBMITTAL NO. :