

PITCH-PAN FLASHING WITH LEAD FLANGE - ISO VIEW

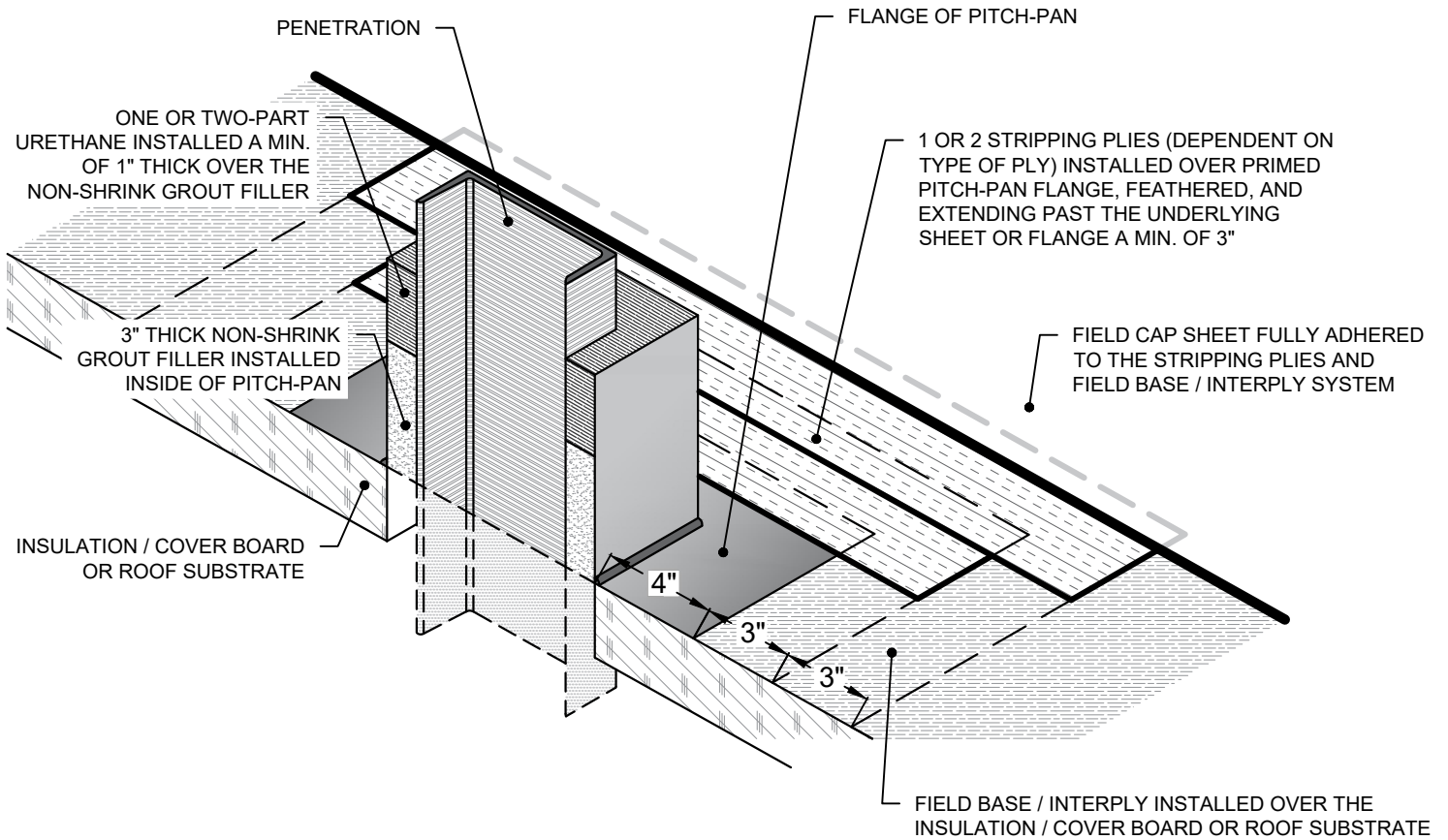

NOTES:

1. SHEET METAL PITCH-PAN A MIN. OF 1" BIGGER AROUND ALL SIDES OF THE PENETRATION WITH A MIN. HEIGHT OF 4" AND DECK SIDE FLANGE OF 4", INSTALLED OVER THE FIELD BASE / INTERPLY IN A LAYER OF ROOF CEMENT.
2. IF FLANGES ARE NOT LEAD, INSTALL WOOD NAILERS TO MATCH HEIGHT OF INSULATION/COVER BOARD AND FASTEN 6" O.C. IN TWO STAGGERED ROWS.
3. PITCH PANS ARE A MAINTENANCE ITEM AND MUST BE MAINTAINED BY THE BUILDING OWNER.

LOW SLOPE 24 - ISO



Rev. 8/21

PROJECT NAME:

ADDRESS:

OWNER:

DATE:

SCALE: NOT TO SCALE

PROJECT NO:

DRAWING NO. :

SUBMITTAL NO. :