

MEMBRANE COVERING FOR WOOD CRICKET / MANSARD - SECTION VIEW

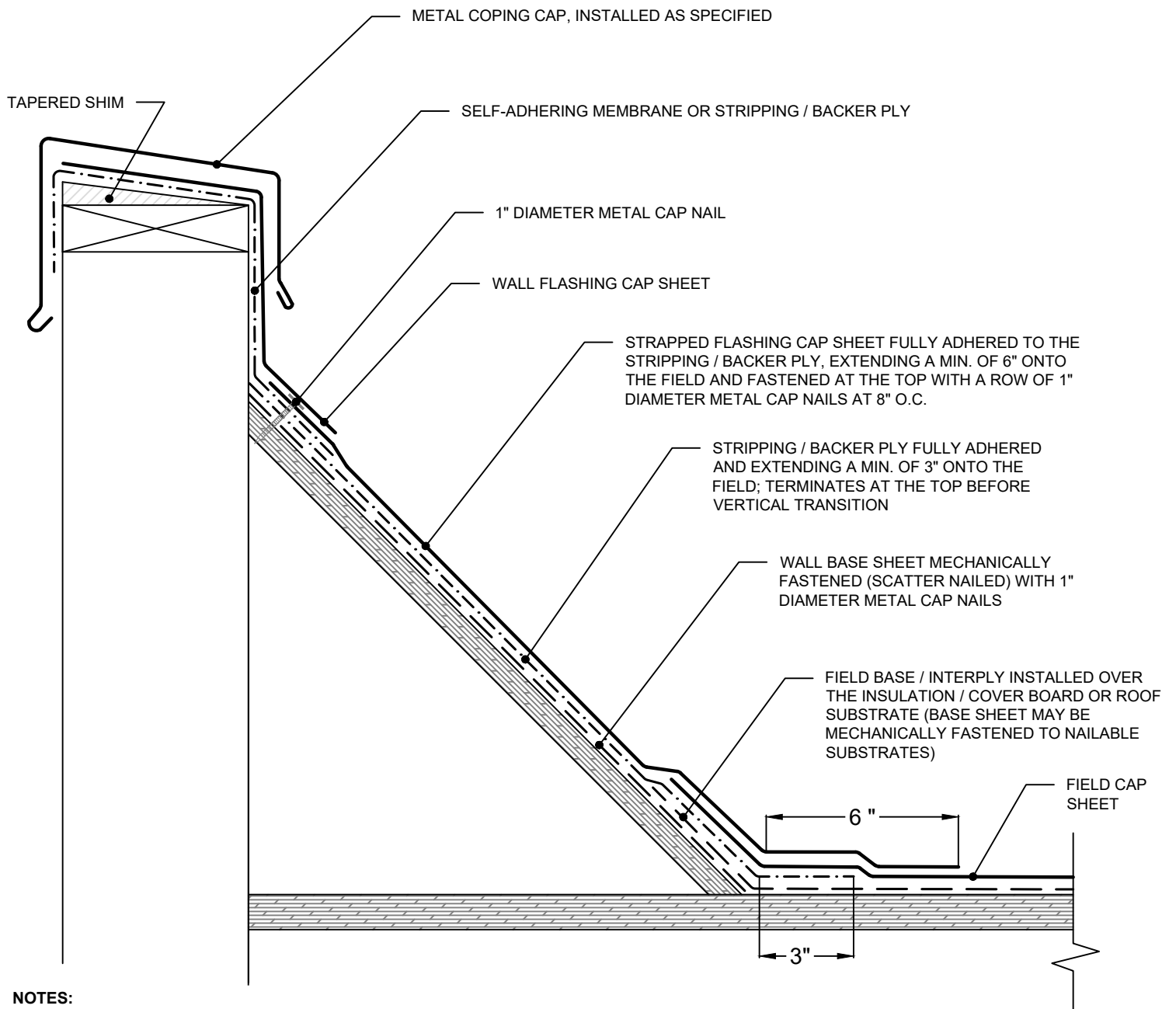

NOTES:

1. INSTALL WALL COVERING AS ILLUSTRATED ABOVE. IF NOT COMPLETELY WRAPPING THE TOP OF THE WALL, MECHANICALLY FASTEN THE TOP OF THE VERTICAL WALL FLASHING CAP SHEET USING 1" DIAMETER GALVANIZED CAP NAILS, 8" O.C.

LOW SLOPE 9 - SEC



Rev. 12/20

PROJECT NAME:

ADDRESS:

OWNER:

DATE:

SCALE: NOT TO SCALE

PROJECT NO:

DRAWING NO. :

SUBMITTAL NO. :