

**TECHNICAL DETAILS**

**FACE HEIGHTS AVAILABLE**

5", 6.5", 8"

**MATERIAL**

24 ga. Steel and  
.040" Aluminum

**TEST COMPLIANCE**

ANSI/SPRI/FM  
4435/ES-1

Factory Mutual Approved

**FEATURES & BENEFITS**

- Twelve-ft. lengths save 20% to 40% in material handling costs
- No stripping-in, heat welding or crimping required
- Wide variety of colors available
- Warranties match applicable NDL terms and conditions
- Tested to comply with the IBC

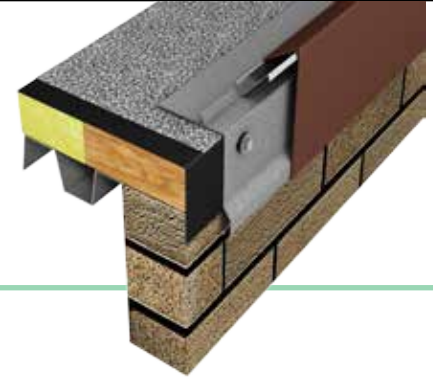

## ENDURA™ EDGE MULTI-PLY OR MODIFIED

**PRODUCT USE**

Endura™ Edge for multi-ply or modified roofing systems protects against high wind events, saving the building from costly damage. The design eliminates the stripping-in typical of other products, making Endura™ Edge fast and easy to install.

**COMPOSITION & MATERIALS**

Endura™ Edge fascia covers are manufactured of 24 ga. steel and .040" aluminum, coated with Kynar 500® finish, and available in many popular colors.

**APPLICATION**

Installation instructions are available at [WWW.MALARKEYROOFING.COM](http://WWW.MALARKEYROOFING.COM), or by contacting our Technical Services Department.

**WARRANTY**

Endura™ Edge is offered with warranties in varying length and wind speeds that match the terms and conditions offered in the applicable Malarkey Materials and Labor Warranty (NDL). For non-NDL applications this product is warranted against manufacturing defects for a period of ten (10) years. A 30-year Kynar 500® finish warranty is included on coil-coated standard colors. Custom post-coated Kynar 500® colors are available with an included 10-year Kynar 500® finish warranty or a 20-year Kynar 500® finish warranty is available upon request. Contact your roofer, local distribution center, or Malarkey for full details. See below for TECHNICAL ASSISTANCE contact information.

Endura™ Edge and other Malarkey products are available throughout North America and Pacific Rim countries. Visit [WWW.MALARKEYROOFING.COM](http://WWW.MALARKEYROOFING.COM) for additional product information and availability.

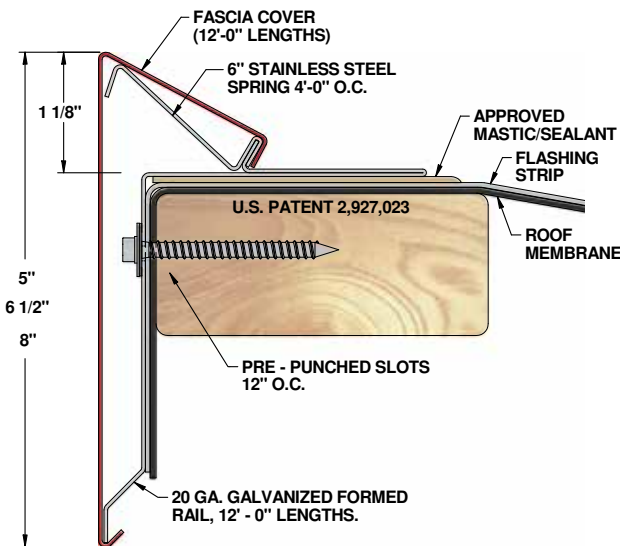

**ENDURA™ EDGE RECYCLED CONTENT**

	RECYCLED CONTENT	POST INDUSTRIAL	POST CONSUMER
<b>GALVANIZED STEEL</b>	25% - 50%	50% - 78%	22% - 50%
<b>3003 ALUMINUM</b>	50%	55%	45%
<b>5005 ALUMINUM</b>	20% - 25%	60%	40%

**TECHNICAL ASSISTANCE:**

Malarkey has technical services assistance available. Contact Malarkey for details: Call weekdays 7:00 am to 5:00 pm PST, at 800.545.1191 or 503.283.1191. [technicalinquiries@malarkeyroofing.com](mailto:technicalinquiries@malarkeyroofing.com)

**CORPORATE OFFICE:**

3131 N. Columbia Blvd. Telephone: 503.283.1191  
Portland, OR 97217-7472 or 800.545.1191  
P.O. Box 17217 Fax: 503.289.7644  
Portland, OR 97217-0217

Effective 9/15  
Supersedes all previously published data

Check for most current version on our website.