

# HEADWALL FLASHING

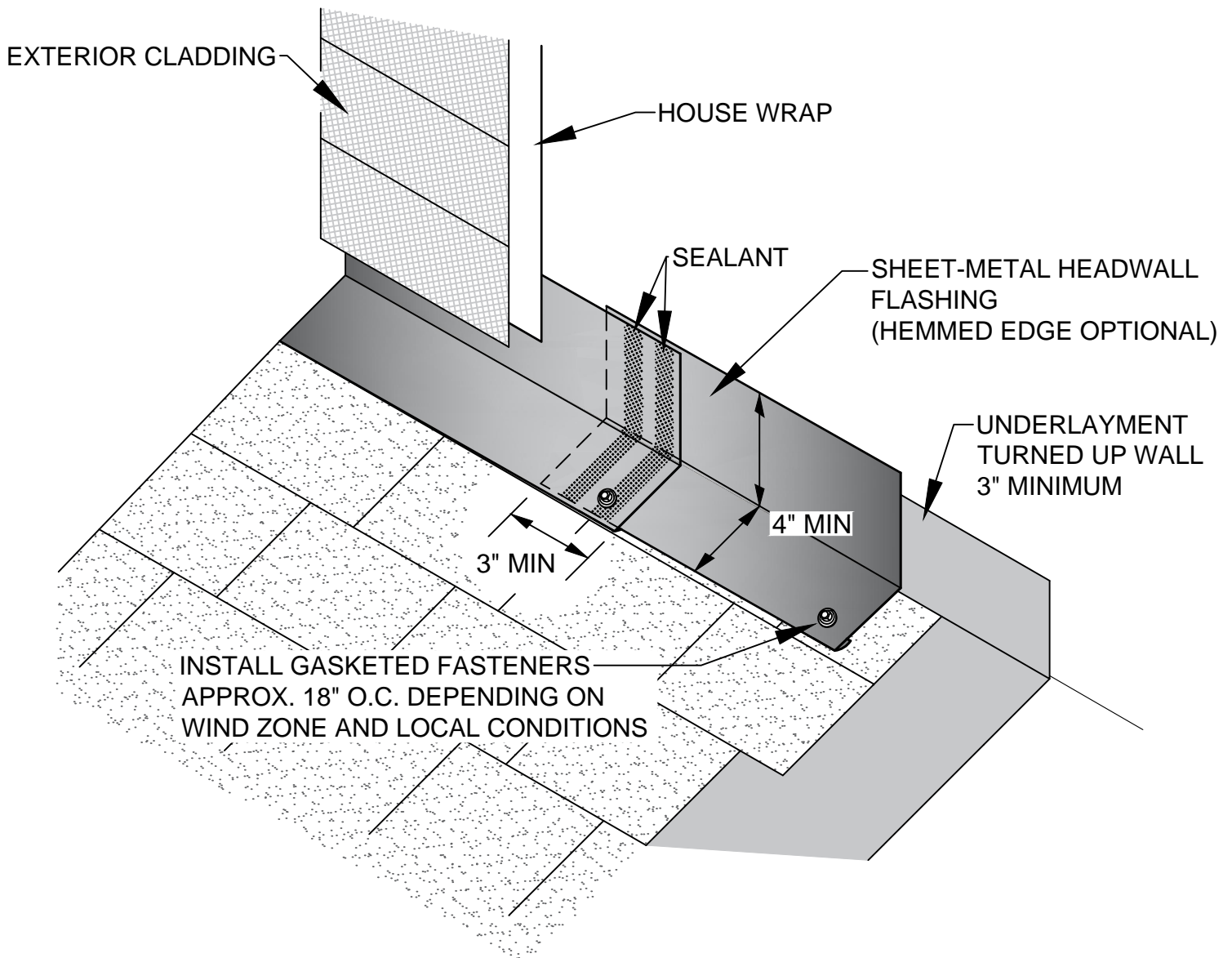

**NOTES:**

- FLASHING AGAINST THE HEADWALL SHOULD BE COUNTER-FLASHED A MINIMUM OF 2" WITH HOUSE WRAP OR OTHER FLASHING AND THEN COVERED WITH THE FINISH WALL CLADDING.
- LAPS IN THE HEADWALL FLASHING SHOULD BE 3" MINIMUM AND THE OVERLAPPING END SET IN A DOUBLE BEAD OF SEALANT.

## STEEP SLOPE 26



Rev. 11/19

PROJECT NAME:

ADDRESS:

OWNER:

DATE:

SCALE: NOT TO SCALE

PROJECT NO:

DRAWING NO. :

SUBMITTAL NO. :